

有限会社ケイテック

URL : <http://k-tech-co-ltd.sakura.ne.jp>

E-MAIL : k-tech@m2.pbc.ne.jp

PHONE : 090-9846-7017

15K Hand-Held Double-Dump Control Guns

- There is an increasing demand for the extra safety of control guns which incorporate dual dump ports. The Advanced Pressure Systems 15K Double Dump Control Guns feature this added security together with the ergonomic advantages and operator comfort of a specially designed front handle.
- This handle is at right angles to the axis of the barrel, which conforms to the natural alignment of the hand and arm of the operator. Some other guns simply use two standard handles, which are cumbersome, uncomfortable to use and are heavier.
- The APS Double Dump Guns are available in 3/8" barrel size.

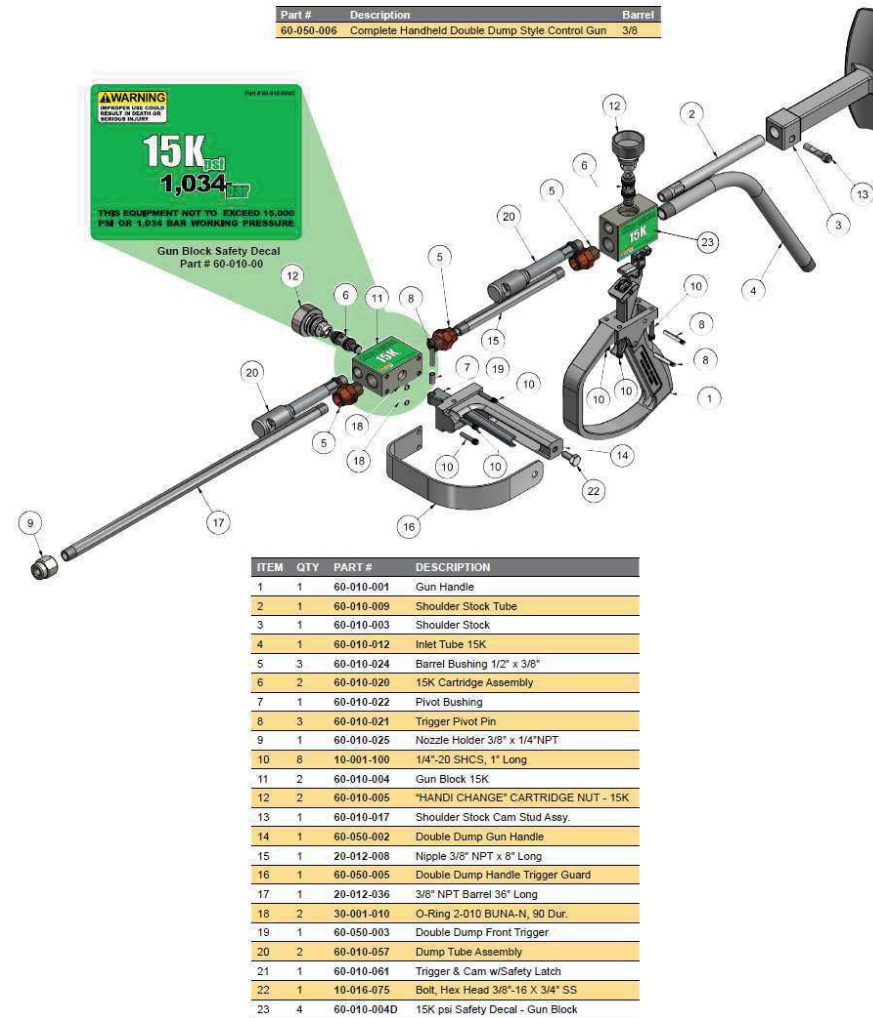

ITEM	QTY	PART #	DESCRIPTION
1	1	60-010-001	Gun Handle
2	1	60-010-009	Shoulder Stock Tube
3	1	60-010-003	Shoulder Stock
4	1	60-010-012	Inlet Tube 15K
5	3	60-010-024	Barrel Bushing 1/2" x 3/8"
6	2	60-010-020	15K Cartridge Assembly
7	1	60-010-022	Pivot Bushing
8	3	60-010-021	Trigger Pivot Pin
9	1	60-010-025	Nozzle Holder 3/8" x 1/4"NPT
10	8	10-001-100	1/4"-20 SHCS, 1" Long
11	2	60-010-004	Gun Block 15K
12	2	60-010-005	"HANDI CHANGE" CARTRIDGE NUT - 15K
13	1	60-010-017	Shoulder Stock Cam Stud Assy.
14	1	60-050-002	Double Dump Gun Handle
15	1	20-012-008	Nipple 3/8" NPT x 8" Long
16	1	60-050-005	Double Dump Handle Trigger Guard
17	1	20-012-036	3/8" NPT Barrel 36" Long
18	2	30-001-010	O-Ring 2-010 BUNA-N, 90 Dur.
19	1	60-050-003	Double Dump Front Trigger
20	2	60-010-057	Dump Tube Assembly
21	1	60-010-061	Trigger & Cam w/Safety Latch
22	1	10-016-075	Bolt, Hex Head 3/8"-16 X 3/4" SS
23	4	60-010-004D	15K psi Safety Decal - Gun Block