

有限会社ケイテック

URL : <http://k-tech-co-ltd.sakura.ne.jp>

E-MAIL : [k-tech@m2.pbc.ne.jp](mailto:k-tech@m2.pbc.ne.jp)

PHONE : 090-9846-7017

### 20K Hand-Heid Double-Dump Control Guns

- There is an increasing demand for the extra safety of control guns which incorporate dual dump ports. The Advanced Pressure Systems 20K Double Dump Control Guns feature this added security together with the ergonomic advantages and operator comfort of a specially designed front handle.
- This handle is at right angles to the axis of the barrel, which conforms to the natural alignment of the hand and arm of the operator. Other guns simply use two standard handles, which are cumbersome, uncomfortable to use and are heavier.
- Front barrels are 48" long with standard 9/16" MP size.

Part #	Description	Barrel
60-055-001	Complete Hand-Heid Double Dump Style Control Gun	9/16"

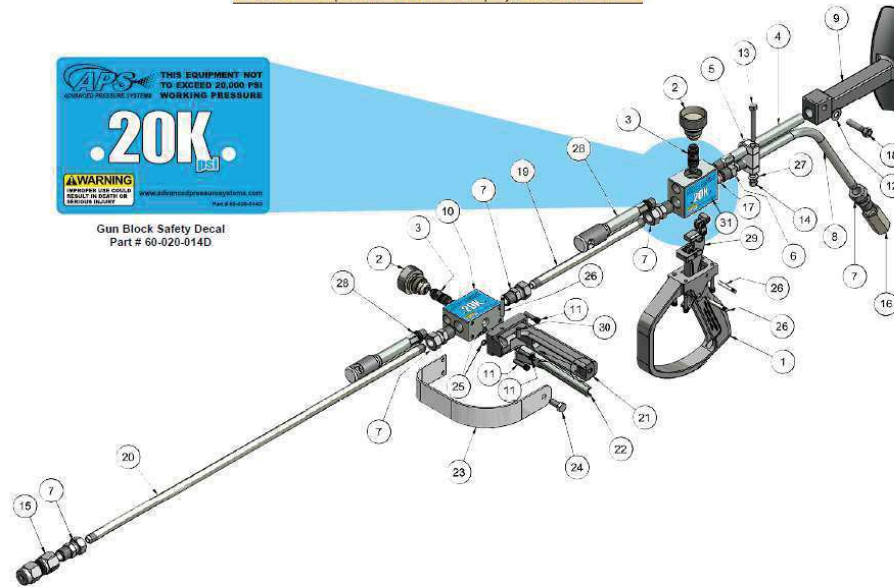

ITEM	QTY	PART #	DESCRIPTION	ITEM	QTY	PART #	DESCRIPTION
1	1	60-010-001	Gun Handle	17	1	21-003-003	9/16" Gland Nut MP
2	2	60-020-005	"Hand Change" Cartridge Nut 20K	18	1	60-010-017	Cam Stud for Shoulder Stock
3	2	60-020-010	Cartridge Assembly 20K	19	1	21-022-010	NIPPLE, 9/16" MP/LH X 10" SS (20K MAWP)
4	1	60-010-009	Shoulder Stock Tube	20	1	21-022-036	NIPPLE, 9/16" MP/LH X 36" SS (20K MAWP)
5	1	60-020-012	Inlet Tube Clamp	21	1	60-050-002	Double Dump Handle
6	1	21-002-003	Collar 9/16" MP	22	1	60-050-003	Double Dump Trigger
7	5	21-005-003	MP Anti-Vibe Assy.	23	1	60-050-005	Double Dump Trigger Guard
8	1	60-020-007	Gun Inlet Tube 20K	24	1	10-016-075	3/8"-16 Bolt, 3/4" long
9	1	60-010-003	Shoulder Stock	25	2	30-001-010	O-Ring 2-010
10	2	60-020-014	BLOCK, 20K CONTROL GUN (NEW)	26	3	60-010-021	Trigger Pivot Pin
11	8	10-001-100	SHCS 1/4"-20 1" Long	27	1	10-010-002	Washer, Flat 5/16"
12	1	10-010-001	3/8" Plain Washer	28	2	60-010-057	Dump Tube Assembly
13	1	10-017-250	Hex Head 5/16"-18 x 2-1/2" Long	29	1	60-010-061	Trigger & Cam Assy. w/Safety Latch
14	1	10-100-003	Nylon Locknut 5/16"-18 SS	30	1	60-010-022	Trigger Pin Pivot Bushing
15	1	17-025-000	Nozzle Holder Assy.20K 9/16" MP (Drop In)	31	4	60-020-014D	20K psi Safety Decal - Gun Block
16	1	21-012-103	Coupler 9/16"MP 20K without Gland Nut & Collar				