

Fan jet nozzle type F $\frac{1}{4}$  (Hex. 17 x 12 mm.  $\frac{1}{4}$ "BSPM)  
 Flachstrahldüse Form F $\frac{1}{4}$  (SW 17 x 12 mm.  $\frac{1}{4}$ "BSP AG)  
 Vlakstraal nozzle type F $\frac{1}{4}$  (Zeskant 17 x 12 mm.  $\frac{1}{4}$ "BSP bu)

扇形ノズルTYPE F1/4

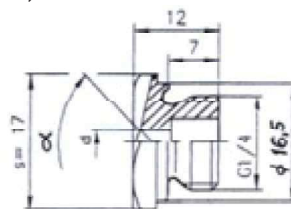

有限会社ケイテック  
 URL : <http://k-tech-co-ltd.sakura.ne.jp>  
 E-MAIL : [k-tech@m2.pbc.ne.jp](mailto:k-tech@m2.pbc.ne.jp)  
 PHONE : 090-9846-7017

O-ring P/N : 98000716

噴射角度

10°

Part No. Teile Nr. Art. Nr.	Orifice mm. + $\alpha$ Bohrung mm + $\alpha$ Nozzle $\phi$ mm + $\alpha$	Part No. Teile Nr. Art. Nr.	Orifice mm. + $\alpha$ Bohrung mm + $\alpha$ Nozzle $\phi$ mm + $\alpha$
F $\frac{1}{4}$ .060.10	$\phi$ 0,60 x 10°	F $\frac{1}{4}$ .280.10	$\phi$ 2,80 x 10°
F $\frac{1}{4}$ .070.10	$\phi$ 0,70 x 10°	F $\frac{1}{4}$ .290.10	$\phi$ 2,90 x 10°
F $\frac{1}{4}$ .080.10	$\phi$ 0,80 x 10°	F $\frac{1}{4}$ .300.10	$\phi$ 3,00 x 10°
F $\frac{1}{4}$ .090.10	$\phi$ 0,90 x 10°	F $\frac{1}{4}$ .310.10	$\phi$ 3,10 x 10°
F $\frac{1}{4}$ .100.10	$\phi$ 1,00 x 10°	F $\frac{1}{4}$ .320.10	$\phi$ 3,20 x 10°
F $\frac{1}{4}$ .110.10	$\phi$ 1,10 x 10°	F $\frac{1}{4}$ .330.10	$\phi$ 3,30 x 10°
F $\frac{1}{4}$ .115.10	$\phi$ 1,15 x 10°	F $\frac{1}{4}$ .340.10	$\phi$ 3,40 x 10°
F $\frac{1}{4}$ .120.10	$\phi$ 1,20 x 10°	F $\frac{1}{4}$ .350.10	$\phi$ 3,50 x 10°
F $\frac{1}{4}$ .130.10	$\phi$ 1,30 x 10°	F $\frac{1}{4}$ .360.10	$\phi$ 3,60 x 10°
F $\frac{1}{4}$ .140.10	$\phi$ 1,40 x 10°	F $\frac{1}{4}$ .370.10	$\phi$ 3,70 x 10°
F $\frac{1}{4}$ .150.10	$\phi$ 1,50 x 10°	F $\frac{1}{4}$ .380.10	$\phi$ 3,80 x 10°
F $\frac{1}{4}$ .160.10	$\phi$ 1,60 x 10°	F $\frac{1}{4}$ .390.10	$\phi$ 3,90 x 10°
F $\frac{1}{4}$ .170.10	$\phi$ 1,70 x 10°	F $\frac{1}{4}$ .400.10	$\phi$ 4,00 x 10°
F $\frac{1}{4}$ .180.10	$\phi$ 1,80 x 10°	F $\frac{1}{4}$ .410.10	$\phi$ 4,10 x 10°
F $\frac{1}{4}$ .190.10	$\phi$ 1,90 x 10°	F $\frac{1}{4}$ .420.10	$\phi$ 4,20 x 10°
F $\frac{1}{4}$ .200.10	$\phi$ 2,00 x 10°	F $\frac{1}{4}$ .430.10	$\phi$ 4,30 x 10°
F $\frac{1}{4}$ .210.10	$\phi$ 2,10 x 10°	F $\frac{1}{4}$ .440.10	$\phi$ 4,40 x 10°
F $\frac{1}{4}$ .220.10	$\phi$ 2,20 x 10°	F $\frac{1}{4}$ .450.10	$\phi$ 4,50 x 10°
F $\frac{1}{4}$ .230.10	$\phi$ 2,30 x 10°	F $\frac{1}{4}$ .460.10	$\phi$ 4,60 x 10°
F $\frac{1}{4}$ .240.10	$\phi$ 2,40 x 10°	F $\frac{1}{4}$ .470.10	$\phi$ 4,70 x 10°
F $\frac{1}{4}$ .250.10	$\phi$ 2,50 x 10°	F $\frac{1}{4}$ .480.10	$\phi$ 4,80 x 10°
F $\frac{1}{4}$ .260.10	$\phi$ 2,60 x 10°	F $\frac{1}{4}$ .490.10	$\phi$ 4,90 x 10°
F $\frac{1}{4}$ .270.10	$\phi$ 2,70 x 10°	F $\frac{1}{4}$ .500.10	$\phi$ 5,00 x 10°

パーツNo.

口径

パーツNo.

口径

Fan jet nozzle type F<sup>1</sup>/<sub>4</sub> (Hex. 17 x 12 mm. 1/4" BSPM)  
 Flachstrahldüse Form F<sup>1</sup>/<sub>4</sub> (SW 17 x 12 mm. 1/4" BSP AG)  
 Vlakstraal nozzle type F<sup>1</sup>/<sub>4</sub> (Zeskant 17 x 12 mm. 1/4" BSP bu)

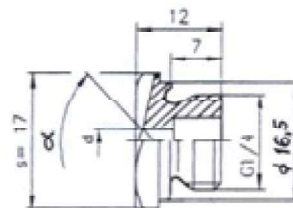

有限会社ケイテック  
 URL : <http://k-tech-co-ltd.sakura.ne.jp>  
 E-MAIL : [k-tech@m2.pbc.ne.jp](mailto:k-tech@m2.pbc.ne.jp)  
 PHONE : 090-9846-7017

O-ring P/N : 98000716

噴射角度

15°

Part No. Teile Nr. Art. Nr.	Orifice mm. + α Bohrung mm + α Nozzle ø mm + α	Part No. Teile Nr. Art. Nr.	Orifice mm. + α Bohrung mm + α Nozzle ø mm + α
F <sup>1</sup> / <sub>4</sub> .060.15	Ø 0,60 x 15°	F <sup>1</sup> / <sub>4</sub> .280.15	Ø 2,80 x 15°
F <sup>1</sup> / <sub>4</sub> .070.15	Ø 0,70 x 15°	F <sup>1</sup> / <sub>4</sub> .290.15	Ø 2,90 x 15°
F <sup>1</sup> / <sub>4</sub> .080.15	Ø 0,80 x 15°	F <sup>1</sup> / <sub>4</sub> .300.15	Ø 3,00 x 15°
F <sup>1</sup> / <sub>4</sub> .090.15	Ø 0,90 x 15°	F <sup>1</sup> / <sub>4</sub> .310.15	Ø 3,10 x 15°
F <sup>1</sup> / <sub>4</sub> .100.15	Ø 1,00 x 15°	F <sup>1</sup> / <sub>4</sub> .320.15	Ø 3,20 x 15°
F <sup>1</sup> / <sub>4</sub> .110.15	Ø 1,10 x 15°	F <sup>1</sup> / <sub>4</sub> .330.15	Ø 3,30 x 15°
F <sup>1</sup> / <sub>4</sub> .115.15	Ø 1,15 x 15°	F <sup>1</sup> / <sub>4</sub> .340.15	Ø 3,40 x 15°
F <sup>1</sup> / <sub>4</sub> .120.15	Ø 1,20 x 15°	F <sup>1</sup> / <sub>4</sub> .350.15	Ø 3,50 x 15°
F <sup>1</sup> / <sub>4</sub> .130.15	Ø 1,30 x 15°	F <sup>1</sup> / <sub>4</sub> .360.15	Ø 3,60 x 15°
F <sup>1</sup> / <sub>4</sub> .140.15	Ø 1,40 x 15°	F <sup>1</sup> / <sub>4</sub> .370.15	Ø 3,70 x 15°
F <sup>1</sup> / <sub>4</sub> .150.15	Ø 1,50 x 15°	F <sup>1</sup> / <sub>4</sub> .380.15	Ø 3,80 x 15°
F <sup>1</sup> / <sub>4</sub> .160.15	Ø 1,60 x 15°	F <sup>1</sup> / <sub>4</sub> .390.15	Ø 3,90 x 15°
F <sup>1</sup> / <sub>4</sub> .170.15	Ø 1,70 x 15°	F <sup>1</sup> / <sub>4</sub> .400.15	Ø 4,00 x 15°
F <sup>1</sup> / <sub>4</sub> .180.15	Ø 1,80 x 15°	F <sup>1</sup> / <sub>4</sub> .410.15	Ø 4,10 x 15°
F <sup>1</sup> / <sub>4</sub> .190.15	Ø 1,90 x 15°	F <sup>1</sup> / <sub>4</sub> .420.15	Ø 4,20 x 15°
F <sup>1</sup> / <sub>4</sub> .200.15	Ø 2,00 x 15°	F <sup>1</sup> / <sub>4</sub> .430.15	Ø 4,30 x 15°
F <sup>1</sup> / <sub>4</sub> .210.15	Ø 2,10 x 15°	F <sup>1</sup> / <sub>4</sub> .440.15	Ø 4,40 x 15°
F <sup>1</sup> / <sub>4</sub> .220.15	Ø 2,20 x 15°	F <sup>1</sup> / <sub>4</sub> .450.15	Ø 4,50 x 15°
F <sup>1</sup> / <sub>4</sub> .230.15	Ø 2,30 x 15°	F <sup>1</sup> / <sub>4</sub> .460.15	Ø 4,60 x 15°
F <sup>1</sup> / <sub>4</sub> .240.15	Ø 2,40 x 15°	F <sup>1</sup> / <sub>4</sub> .470.15	Ø 4,70 x 15°
F <sup>1</sup> / <sub>4</sub> .250.15	Ø 2,50 x 15°	F <sup>1</sup> / <sub>4</sub> .480.15	Ø 4,80 x 15°
F <sup>1</sup> / <sub>4</sub> .260.15	Ø 2,60 x 15°	F <sup>1</sup> / <sub>4</sub> .490.15	Ø 4,90 x 15°
F <sup>1</sup> / <sub>4</sub> .270.15	Ø 2,70 x 15°	F <sup>1</sup> / <sub>4</sub> .500.15	Ø 5,00 x 15°

パーツ No.

口径

パーツ No.

口径

**Fan jet nozzle type F<sup>1</sup>/<sub>4</sub> (Hex. 17 x 12 mm. 1/4" BSPM)**  
**Flachstrahldüse Form F<sup>1</sup>/<sub>4</sub> (SW 17 x 12 mm. 1/4" BSP AG)**  
**Vlakstraal nozzle type F<sup>1</sup>/<sub>4</sub> (Zeskant 17 x 12 mm. 1/4" BSP bu)**

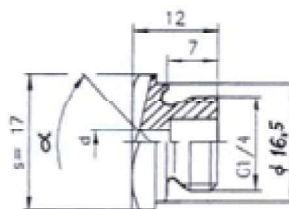

有限会社ケイテック  
 URL : <http://k-tech-co-ltd.sakura.ne.jp>  
 E-MAIL : [k-tech@m2.pbc.ne.jp](mailto:k-tech@m2.pbc.ne.jp)  
 PHONE : 090-9846-7017

O-ring P/N : 98000716

噴射角度

20°

Part No. Teile Nr. Art. Nr.	Orifice mm. + α Bohrung mm + α Nozzle ø mm + α	Part No. Teile Nr. Art. Nr.	Orifice mm. + α Bohrung mm + α Nozzle ø mm + α
F <sup>1</sup> / <sub>4</sub> .060.20	Ø 0,60 x 20°	F <sup>1</sup> / <sub>4</sub> .280.20	Ø 2,80 x 20°
F <sup>1</sup> / <sub>4</sub> .070.20	Ø 0,70 x 20°	F <sup>1</sup> / <sub>4</sub> .290.20	Ø 2,90 x 20°
F <sup>1</sup> / <sub>4</sub> .080.20	Ø 0,80 x 20°	F <sup>1</sup> / <sub>4</sub> .300.20	Ø 3,00 x 20°
F <sup>1</sup> / <sub>4</sub> .090.20	Ø 0,90 x 20°	F <sup>1</sup> / <sub>4</sub> .310.20	Ø 3,10 x 20°
F <sup>1</sup> / <sub>4</sub> .100.20	Ø 1,00 x 20°	F <sup>1</sup> / <sub>4</sub> .320.20	Ø 3,20 x 20°
F <sup>1</sup> / <sub>4</sub> .110.20	Ø 1,10 x 20°	F <sup>1</sup> / <sub>4</sub> .330.20	Ø 3,30 x 20°
F <sup>1</sup> / <sub>4</sub> .115.20	Ø 1,15 x 20°	F <sup>1</sup> / <sub>4</sub> .340.20	Ø 3,40 x 20°
F <sup>1</sup> / <sub>4</sub> .120.20	Ø 1,20 x 20°	F <sup>1</sup> / <sub>4</sub> .350.20	Ø 3,50 x 20°
F <sup>1</sup> / <sub>4</sub> .130.20	Ø 1,30 x 20°	F <sup>1</sup> / <sub>4</sub> .360.20	Ø 3,60 x 20°
F <sup>1</sup> / <sub>4</sub> .140.20	Ø 1,40 x 20°	F <sup>1</sup> / <sub>4</sub> .370.20	Ø 3,70 x 20°
F <sup>1</sup> / <sub>4</sub> .150.20	Ø 1,50 x 20°	F <sup>1</sup> / <sub>4</sub> .380.20	Ø 3,80 x 20°
F <sup>1</sup> / <sub>4</sub> .160.20	Ø 1,60 x 20°	F <sup>1</sup> / <sub>4</sub> .390.20	Ø 3,90 x 20°
F <sup>1</sup> / <sub>4</sub> .170.20	Ø 1,70 x 20°	F <sup>1</sup> / <sub>4</sub> .400.20	Ø 4,00 x 20°
F <sup>1</sup> / <sub>4</sub> .180.20	Ø 1,80 x 20°	F <sup>1</sup> / <sub>4</sub> .410.20	Ø 4,10 x 20°
F <sup>1</sup> / <sub>4</sub> .190.20	Ø 1,90 x 20°	F <sup>1</sup> / <sub>4</sub> .420.20	Ø 4,20 x 20°
F <sup>1</sup> / <sub>4</sub> .200.20	Ø 2,00 x 20°	F <sup>1</sup> / <sub>4</sub> .430.20	Ø 4,30 x 20°
F <sup>1</sup> / <sub>4</sub> .210.20	Ø 2,10 x 20°	F <sup>1</sup> / <sub>4</sub> .440.20	Ø 4,40 x 20°
F <sup>1</sup> / <sub>4</sub> .220.20	Ø 2,20 x 20°	F <sup>1</sup> / <sub>4</sub> .450.20	Ø 4,50 x 20°
F <sup>1</sup> / <sub>4</sub> .230.20	Ø 2,30 x 20°	F <sup>1</sup> / <sub>4</sub> .460.20	Ø 4,60 x 20°
F <sup>1</sup> / <sub>4</sub> .240.20	Ø 2,40 x 20°	F <sup>1</sup> / <sub>4</sub> .470.20	Ø 4,70 x 20°
F <sup>1</sup> / <sub>4</sub> .250.20	Ø 2,50 x 20°	F <sup>1</sup> / <sub>4</sub> .480.20	Ø 4,80 x 20°
F <sup>1</sup> / <sub>4</sub> .260.20	Ø 2,60 x 20°	F <sup>1</sup> / <sub>4</sub> .490.20	Ø 4,90 x 20°
F <sup>1</sup> / <sub>4</sub> .270.20	Ø 2,70 x 20°	F <sup>1</sup> / <sub>4</sub> .500.20	Ø 5,00 x 20°

パーツNo.

口径

パーツNo.

口径

Fan jet nozzle type F<sup>1</sup>/<sub>4</sub> (Hex. 17 x 12 mm. 1/4" BSPM)  
 Flachstrahldüse Form F<sup>1</sup>/<sub>4</sub> (SW 17 x 12 mm. 1/4" BSP AG)  
 Vlakstraal nozzle type F<sup>1</sup>/<sub>4</sub> (Zeskant 17 x 12 mm. 1/4" BSP bu)

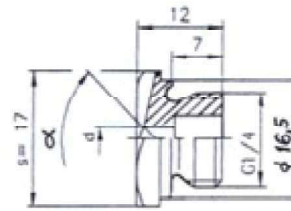

有限会社ケイテック  
 URL : <http://k-tech-co-ltd.sakura.ne.jp>  
 E-MAIL : [k-tech@m2.pbc.ne.jp](mailto:k-tech@m2.pbc.ne.jp)  
 PHONE : 090-9846-7017

O-ring P/N : 98000716

噴射角度

30°

Part No. Teile Nr. Art. Nr.	Orifice mm. + α Bohrung mm + α Nozzle ø mm + α	Part No. Teile Nr. Art. Nr.	Orifice mm. + α Bohrung mm + α Nozzle ø mm + α
F <sup>1</sup> / <sub>4</sub> .060.30	Ø 0,60 x 30°	F <sup>1</sup> / <sub>4</sub> .280.30	Ø 2,80 x 30°
F <sup>1</sup> / <sub>4</sub> .070.30	Ø 0,70 x 30°	F <sup>1</sup> / <sub>4</sub> .290.30	Ø 2,90 x 30°
F <sup>1</sup> / <sub>4</sub> .080.30	Ø 0,80 x 30°	F <sup>1</sup> / <sub>4</sub> .300.30	Ø 3,00 x 30°
F <sup>1</sup> / <sub>4</sub> .090.30	Ø 0,90 x 30°	F <sup>1</sup> / <sub>4</sub> .310.30	Ø 3,10 x 30°
F <sup>1</sup> / <sub>4</sub> .100.30	Ø 1,00 x 30°	F <sup>1</sup> / <sub>4</sub> .320.30	Ø 3,20 x 30°
F <sup>1</sup> / <sub>4</sub> .110.30	Ø 1,10 x 30°	F <sup>1</sup> / <sub>4</sub> .330.30	Ø 3,30 x 30°
F <sup>1</sup> / <sub>4</sub> .115.30	Ø 1,15 x 30°	F <sup>1</sup> / <sub>4</sub> .340.30	Ø 3,40 x 30°
F <sup>1</sup> / <sub>4</sub> .120.30	Ø 1,20 x 30°	F <sup>1</sup> / <sub>4</sub> .350.30	Ø 3,50 x 30°
F <sup>1</sup> / <sub>4</sub> .130.30	Ø 1,30 x 30°	F <sup>1</sup> / <sub>4</sub> .360.30	Ø 3,60 x 30°
F <sup>1</sup> / <sub>4</sub> .140.30	Ø 1,40 x 30°	F <sup>1</sup> / <sub>4</sub> .370.30	Ø 3,70 x 30°
F <sup>1</sup> / <sub>4</sub> .150.30	Ø 1,50 x 30°	F <sup>1</sup> / <sub>4</sub> .380.30	Ø 3,80 x 30°
F <sup>1</sup> / <sub>4</sub> .160.30	Ø 1,60 x 30°	F <sup>1</sup> / <sub>4</sub> .390.30	Ø 3,90 x 30°
F <sup>1</sup> / <sub>4</sub> .170.30	Ø 1,70 x 30°	F <sup>1</sup> / <sub>4</sub> .400.30	Ø 4,00 x 30°
F <sup>1</sup> / <sub>4</sub> .180.30	Ø 1,80 x 30°	F <sup>1</sup> / <sub>4</sub> .410.30	Ø 4,10 x 30°
F <sup>1</sup> / <sub>4</sub> .190.30	Ø 1,90 x 30°	F <sup>1</sup> / <sub>4</sub> .420.30	Ø 4,20 x 30°
F <sup>1</sup> / <sub>4</sub> .200.30	Ø 2,00 x 30°	F <sup>1</sup> / <sub>4</sub> .430.30	Ø 4,30 x 30°
F <sup>1</sup> / <sub>4</sub> .210.30	Ø 2,10 x 30°	F <sup>1</sup> / <sub>4</sub> .440.30	Ø 4,40 x 30°
F <sup>1</sup> / <sub>4</sub> .220.30	Ø 2,20 x 30°	F <sup>1</sup> / <sub>4</sub> .450.30	Ø 4,50 x 30°
F <sup>1</sup> / <sub>4</sub> .230.30	Ø 2,30 x 30°	F <sup>1</sup> / <sub>4</sub> .460.30	Ø 4,60 x 30°
F <sup>1</sup> / <sub>4</sub> .240.30	Ø 2,40 x 30°	F <sup>1</sup> / <sub>4</sub> .470.30	Ø 4,70 x 30°
F <sup>1</sup> / <sub>4</sub> .250.30	Ø 2,50 x 30°	F <sup>1</sup> / <sub>4</sub> .480.30	Ø 4,80 x 30°
F <sup>1</sup> / <sub>4</sub> .260.30	Ø 2,60 x 30°	F <sup>1</sup> / <sub>4</sub> .490.30	Ø 4,90 x 30°
F <sup>1</sup> / <sub>4</sub> .270.30	Ø 2,70 x 30°	F <sup>1</sup> / <sub>4</sub> .500.30	Ø 5,00 x 30°

パーツNo.

口径

パーツNo.

口径

**Fan jet nozzle type F $\frac{1}{4}$  (Hex. 17 x 12 mm.  $\frac{1}{4}$ "BSPM)  
 Flachstrahldüse Form F $\frac{1}{4}$  (SW 17 x 12 mm.  $\frac{1}{4}$ "BSP AG)  
 Vlakstraal nozzle type F $\frac{1}{4}$  (Zeskant 17 x 12 mm.  $\frac{1}{4}$ "BSP bu)**

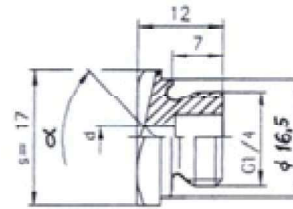

有限会社ケイテック  
 URL : <http://k-tech-co-ltd.sakura.ne.jp>  
 E-MAIL : [k-tech@m2.pbc.ne.jp](mailto:k-tech@m2.pbc.ne.jp)  
 PHONE : 090-9846-7017

O-ring P/N : 98000716

噴射角度

45°			
Part No. Teile Nr. Art. Nr.	Orifice mm. + $\alpha$ Bohrung mm + $\alpha$ Nozzle $\phi$ mm + $\alpha$	Part No. Teile Nr. Art. Nr.	Orifice mm. + $\alpha$ Bohrung mm + $\alpha$ Nozzle $\phi$ mm + $\alpha$
F $\frac{1}{4}$ .060.45	$\phi$ 0,60 x 45°	F $\frac{1}{4}$ .280.45	$\phi$ 2,80 x 45°
F $\frac{1}{4}$ .070.45	$\phi$ 0,70 x 45°	F $\frac{1}{4}$ .290.45	$\phi$ 2,90 x 45°
F $\frac{1}{4}$ .080.45	$\phi$ 0,80 x 45°	F $\frac{1}{4}$ .300.45	$\phi$ 3,00 x 45°
F $\frac{1}{4}$ .090.45	$\phi$ 0,90 x 45°	F $\frac{1}{4}$ .310.45	$\phi$ 3,10 x 45°
F $\frac{1}{4}$ .100.45	$\phi$ 1,00 x 45°	F $\frac{1}{4}$ .320.45	$\phi$ 3,20 x 45°
F $\frac{1}{4}$ .110.45	$\phi$ 1,10 x 45°	F $\frac{1}{4}$ .330.45	$\phi$ 3,30 x 45°
F $\frac{1}{4}$ .115.45	$\phi$ 1,15 x 45°	F $\frac{1}{4}$ .340.45	$\phi$ 3,40 x 45°
F $\frac{1}{4}$ .120.45	$\phi$ 1,20 x 45°	F $\frac{1}{4}$ .350.45	$\phi$ 3,50 x 45°
F $\frac{1}{4}$ .130.45	$\phi$ 1,30 x 45°	F $\frac{1}{4}$ .360.45	$\phi$ 3,60 x 45°
F $\frac{1}{4}$ .140.45	$\phi$ 1,40 x 45°	F $\frac{1}{4}$ .370.45	$\phi$ 3,70 x 45°
F $\frac{1}{4}$ .150.45	$\phi$ 1,50 x 45°	F $\frac{1}{4}$ .380.45	$\phi$ 3,80 x 45°
F $\frac{1}{4}$ .160.45	$\phi$ 1,60 x 45°	F $\frac{1}{4}$ .390.45	$\phi$ 3,90 x 45°
F $\frac{1}{4}$ .170.45	$\phi$ 1,70 x 45°	F $\frac{1}{4}$ .400.45	$\phi$ 4,00 x 45°
F $\frac{1}{4}$ .180.45	$\phi$ 1,80 x 45°	F $\frac{1}{4}$ .410.45	$\phi$ 4,10 x 45°
F $\frac{1}{4}$ .190.45	$\phi$ 1,90 x 45°	F $\frac{1}{4}$ .420.45	$\phi$ 4,20 x 45°
F $\frac{1}{4}$ .200.45	$\phi$ 2,00 x 45°	F $\frac{1}{4}$ .430.45	$\phi$ 4,30 x 45°
F $\frac{1}{4}$ .210.45	$\phi$ 2,10 x 45°	F $\frac{1}{4}$ .440.45	$\phi$ 4,40 x 45°
F $\frac{1}{4}$ .220.45	$\phi$ 2,20 x 45°	F $\frac{1}{4}$ .450.45	$\phi$ 4,50 x 45°
F $\frac{1}{4}$ .230.45	$\phi$ 2,30 x 45°	F $\frac{1}{4}$ .460.45	$\phi$ 4,60 x 45°
F $\frac{1}{4}$ .240.45	$\phi$ 2,40 x 45°	F $\frac{1}{4}$ .470.45	$\phi$ 4,70 x 45°
F $\frac{1}{4}$ .250.45	$\phi$ 2,50 x 45°	F $\frac{1}{4}$ .480.45	$\phi$ 4,80 x 45°
F $\frac{1}{4}$ .260.45	$\phi$ 2,60 x 45°	F $\frac{1}{4}$ .490.45	$\phi$ 4,90 x 45°
F $\frac{1}{4}$ .270.45	$\phi$ 2,70 x 45°	F $\frac{1}{4}$ .500.45	$\phi$ 5,00 x 45°

パーツNo.

口径

パーツNo.

口径

**Fan jet nozzle type F $\frac{1}{4}$  (Hex. 17 x 12 mm.  $\frac{1}{4}$ "BSPM)  
 Flachstrahldüse Form F $\frac{1}{4}$  (SW 17 x 12 mm.  $\frac{1}{4}$ "BSP AG)  
 Vlakstraal nozzle type F $\frac{1}{4}$  (Zeskant 17 x 12 mm.  $\frac{1}{4}$ "BSP bu)**

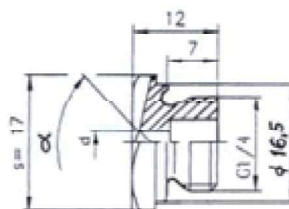

有限会社ケイテック  
 URL : <http://k-tech-co-ltd.sakura.ne.jp>  
 E-MAIL : [k-tech@m2.pbc.ne.jp](mailto:k-tech@m2.pbc.ne.jp)  
 PHONE : 090-9846-7017

O-ring P/N : 98000716

噴射角度

**60°**

Part No. Teile Nr. Art. Nr.	Orifice mm. + α Bohrung mm + α Nozzle ø mm + α	Part No. Teile Nr. Art. Nr.	Orifice mm.+ α Bohrung mm + α Nozzle ø mm + α
F $\frac{1}{4}$ .060.60	Ø 0,60 x 60°	F $\frac{1}{4}$ .280.60	Ø 2,80 x 60°
F $\frac{1}{4}$ .070.60	Ø 0,70 x 60°	F $\frac{1}{4}$ .290.60	Ø 2,90 x 60°
F $\frac{1}{4}$ .080.60	Ø 0,80 x 60°	F $\frac{1}{4}$ .300.60	Ø 3,00 x 60°
F $\frac{1}{4}$ .090.60	Ø 0,90 x 60°	F $\frac{1}{4}$ .310.60	Ø 3,10 x 60°
F $\frac{1}{4}$ .100.60	Ø 1,00 x 60°	F $\frac{1}{4}$ .320.60	Ø 3,20 x 60°
F $\frac{1}{4}$ .110.60	Ø 1,10 x 60°	F $\frac{1}{4}$ .330.60	Ø 3,30 x 60°
F $\frac{1}{4}$ .115.60	Ø 1,15 x 60°	F $\frac{1}{4}$ .340.60	Ø 3,40 x 60°
F $\frac{1}{4}$ .120.60	Ø 1,20 x 60°	F $\frac{1}{4}$ .350.60	Ø 3,50 x 60°
F $\frac{1}{4}$ .130.60	Ø 1,30 x 60°	F $\frac{1}{4}$ .360.60	Ø 3,60 x 60°
F $\frac{1}{4}$ .140.60	Ø 1,40 x 60°	F $\frac{1}{4}$ .370.60	Ø 3,70 x 60°
F $\frac{1}{4}$ .150.60	Ø 1,50 x 60°	F $\frac{1}{4}$ .380.60	Ø 3,80 x 60°
F $\frac{1}{4}$ .160.60	Ø 1,60 x 60°	F $\frac{1}{4}$ .390.60	Ø 3,90 x 60°
F $\frac{1}{4}$ .170.60	Ø 1,70 x 60°	F $\frac{1}{4}$ .400.60	Ø 4,00 x 60°
F $\frac{1}{4}$ .180.60	Ø 1,80 x 60°	F $\frac{1}{4}$ .410.60	Ø 4,10 x 60°
F $\frac{1}{4}$ .190.60	Ø 1,90 x 60°	F $\frac{1}{4}$ .420.60	Ø 4,20 x 60°
F $\frac{1}{4}$ .200.60	Ø 2,00 x 60°	F $\frac{1}{4}$ .430.60	Ø 4,30 x 60°
F $\frac{1}{4}$ .210.60	Ø 2,10 x 60°	F $\frac{1}{4}$ .440.60	Ø 4,40 x 60°
F $\frac{1}{4}$ .220.60	Ø 2,20 x 60°	F $\frac{1}{4}$ .450.60	Ø 4,50 x 60°
F $\frac{1}{4}$ .230.60	Ø 2,30 x 60°	F $\frac{1}{4}$ .460.60	Ø 4,60 x 60°
F $\frac{1}{4}$ .240.60	Ø 2,40 x 60°	F $\frac{1}{4}$ .470.60	Ø 4,70 x 60°
F $\frac{1}{4}$ .250.60	Ø 2,50 x 60°	F $\frac{1}{4}$ .480.60	Ø 4,80 x 60°
F $\frac{1}{4}$ .260.60	Ø 2,60 x 60°	F $\frac{1}{4}$ .490.60	Ø 4,90 x 60°
F $\frac{1}{4}$ .270.60	Ø 2,70 x 60°	F $\frac{1}{4}$ .500.60	Ø 5,00 x 60°

パーツNo. 口径

パーツNo. 口径



**Fan jet nozzle type F<sup>1</sup>/<sub>4</sub> (Hex. 17 x 12 mm. 1/4" BSPM)**  
**Flachstrahldüse Form F<sup>1</sup>/<sub>4</sub> (SW 17 x 12 mm. 1/4" BSP AG)**  
**Vlakstraal nozzle type F<sup>1</sup>/<sub>4</sub> (Zeskant 17 x 12 mm. 1/4" BSP bu)**

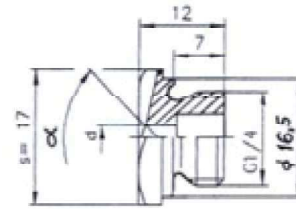

有限会社ケイテック

URL : <http://k-tech-co-ltd.sakura.ne.jp>

E-MAIL : [k-tech@m2.pbc.ne.jp](mailto:k-tech@m2.pbc.ne.jp)

PHONE : 090-9846-7017

O-ring P/N : 98000716 噴射角度

**90°**

Part No. Teile Nr. Art. Nr.	Orifice mm. + α Bohrung mm + α Nozzle Ø mm + α	Part No. Teile Nr. Art. Nr.	Orifice mm. + α Bohrung mm + α Nozzle Ø mm + α
F <sup>1</sup> / <sub>4</sub> .060.90	Ø 0,60 x 90°	F <sup>1</sup> / <sub>4</sub> .280.90	Ø 2,80 x 90°
F <sup>1</sup> / <sub>4</sub> .070.90	Ø 0,70 x 90°	F <sup>1</sup> / <sub>4</sub> .290.90	Ø 2,90 x 90°
F <sup>1</sup> / <sub>4</sub> .080.90	Ø 0,80 x 90°	F <sup>1</sup> / <sub>4</sub> .300.90	Ø 3,00 x 90°
F <sup>1</sup> / <sub>4</sub> .090.90	Ø 0,90 x 90°	F <sup>1</sup> / <sub>4</sub> .310.90	Ø 3,10 x 90°
F <sup>1</sup> / <sub>4</sub> .100.90	Ø 1,00 x 90°	F <sup>1</sup> / <sub>4</sub> .320.90	Ø 3,20 x 90°
F <sup>1</sup> / <sub>4</sub> .110.90	Ø 1,10 x 90°	F <sup>1</sup> / <sub>4</sub> .330.90	Ø 3,30 x 90°
F <sup>1</sup> / <sub>4</sub> .115.90	Ø 1,15 x 90°	F <sup>1</sup> / <sub>4</sub> .340.90	Ø 3,40 x 90°
F <sup>1</sup> / <sub>4</sub> .120.90	Ø 1,20 x 90°	F <sup>1</sup> / <sub>4</sub> .350.90	Ø 3,50 x 90°
F <sup>1</sup> / <sub>4</sub> .130.90	Ø 1,30 x 90°	F <sup>1</sup> / <sub>4</sub> .360.90	Ø 3,60 x 90°
F <sup>1</sup> / <sub>4</sub> .140.90	Ø 1,40 x 90°	F <sup>1</sup> / <sub>4</sub> .370.90	Ø 3,70 x 90°
F <sup>1</sup> / <sub>4</sub> .150.90	Ø 1,50 x 90°	F <sup>1</sup> / <sub>4</sub> .380.90	Ø 3,80 x 90°
F <sup>1</sup> / <sub>4</sub> .160.90	Ø 1,60 x 90°	F <sup>1</sup> / <sub>4</sub> .390.90	Ø 3,90 x 90°
F <sup>1</sup> / <sub>4</sub> .170.90	Ø 1,70 x 90°	F <sup>1</sup> / <sub>4</sub> .400.90	Ø 4,00 x 90°
F <sup>1</sup> / <sub>4</sub> .180.90	Ø 1,80 x 90°	F <sup>1</sup> / <sub>4</sub> .410.90	Ø 4,10 x 90°
F <sup>1</sup> / <sub>4</sub> .190.90	Ø 1,90 x 90°	F <sup>1</sup> / <sub>4</sub> .420.90	Ø 4,20 x 90°
F <sup>1</sup> / <sub>4</sub> .200.90	Ø 2,00 x 90°	F <sup>1</sup> / <sub>4</sub> .430.90	Ø 4,30 x 90°
F <sup>1</sup> / <sub>4</sub> .210.90	Ø 2,10 x 90°	F <sup>1</sup> / <sub>4</sub> .440.90	Ø 4,40 x 90°
F <sup>1</sup> / <sub>4</sub> .220.90	Ø 2,20 x 90°	F <sup>1</sup> / <sub>4</sub> .450.90	Ø 4,50 x 90°
F <sup>1</sup> / <sub>4</sub> .230.90	Ø 2,30 x 90°	F <sup>1</sup> / <sub>4</sub> .460.90	Ø 4,60 x 90°
F <sup>1</sup> / <sub>4</sub> .240.90	Ø 2,40 x 90°	F <sup>1</sup> / <sub>4</sub> .470.90	Ø 4,70 x 90°
F <sup>1</sup> / <sub>4</sub> .250.90	Ø 2,50 x 90°	F <sup>1</sup> / <sub>4</sub> .480.90	Ø 4,80 x 90°
F <sup>1</sup> / <sub>4</sub> .260.90	Ø 2,60 x 90°	F <sup>1</sup> / <sub>4</sub> .490.90	Ø 4,90 x 90°
F <sup>1</sup> / <sub>4</sub> .270.90	Ø 2,70 x 90°	F <sup>1</sup> / <sub>4</sub> .500.90	Ø 5,00 x 90°

パーツ No.

口径

パーツ No.

口径

Fan jet nozzle type F $\frac{1}{4}$  (Hex. 17 x 12 mm.  $\frac{1}{4}$ "BSPM)  
 Flachstrahldüse Form F $\frac{1}{4}$  (SW 17 x 12 mm.  $\frac{1}{4}$ "BSP AG)  
 Vlakstraal nozzle type F $\frac{1}{4}$  (Zeskant 17 x 12 mm.  $\frac{1}{4}$ "BSP bu)

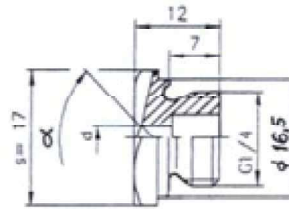

有限会社ケイテック  
 URL : <http://k-tech-co-ltd.sakura.ne.jp>  
 E-MAIL : [k-tech@m2.pbc.ne.jp](mailto:k-tech@m2.pbc.ne.jp)  
 PHONE : 090-9846-7017

O-ring P/N : 98000716

噴射角度

120°

Part No. Teile Nr. Art. Nr.	Orifice mm. + α Bohrung mm + α Nozzle ø mm + α	Part No. Teile Nr. Art. Nr.	Orifice mm.+ α Bohrung mm + α Nozzle ø mm + α
F $\frac{1}{4}$ .060.120	Ø 0,60 x 120°	F $\frac{1}{4}$ .280.120	Ø 2,80 x 120°
F $\frac{1}{4}$ .070.120	Ø 0,70 x 120°	F $\frac{1}{4}$ .290.120	Ø 2,90 x 120°
F $\frac{1}{4}$ .080.120	Ø 0,80 x 120°	F $\frac{1}{4}$ .300.120	Ø 3,00 x 120°
F $\frac{1}{4}$ .090.120	Ø 0,90 x 120°	F $\frac{1}{4}$ .310.120	Ø 3,10 x 120°
F $\frac{1}{4}$ .100.120	Ø 1,00 x 120°	F $\frac{1}{4}$ .320.120	Ø 3,20 x 120°
F $\frac{1}{4}$ .110.120	Ø 1,10 x 120°	F $\frac{1}{4}$ .330.120	Ø 3,30 x 120°
F $\frac{1}{4}$ .115.120	Ø 1,15 x 120°	F $\frac{1}{4}$ .340.120	Ø 3,40 x 120°
F $\frac{1}{4}$ .120.120	Ø 1,20 x 120°	F $\frac{1}{4}$ .350.120	Ø 3,50 x 120°
F $\frac{1}{4}$ .130.120	Ø 1,30 x 120°	F $\frac{1}{4}$ .360.120	Ø 3,60 x 120°
F $\frac{1}{4}$ .140.120	Ø 1,40 x 120°	F $\frac{1}{4}$ .370.120	Ø 3,70 x 120°
F $\frac{1}{4}$ .150.120	Ø 1,50 x 120°	F $\frac{1}{4}$ .380.120	Ø 3,80 x 120°
F $\frac{1}{4}$ .160.120	Ø 1,60 x 120°	F $\frac{1}{4}$ .390.120	Ø 3,90 x 120°
F $\frac{1}{4}$ .170.120	Ø 1,70 x 120°	F $\frac{1}{4}$ .400.120	Ø 4,00 x 120°
F $\frac{1}{4}$ .180.120	Ø 1,80 x 120°	F $\frac{1}{4}$ .410.120	Ø 4,10 x 120°
F $\frac{1}{4}$ .190.120	Ø 1,90 x 120°	F $\frac{1}{4}$ .420.120	Ø 4,20 x 120°
F $\frac{1}{4}$ .200.120	Ø 2,00 x 120°	F $\frac{1}{4}$ .430.120	Ø 4,30 x 120°
F $\frac{1}{4}$ .210.120	Ø 2,10 x 120°	F $\frac{1}{4}$ .440.120	Ø 4,40 x 120°
F $\frac{1}{4}$ .220.120	Ø 2,20 x 120°	F $\frac{1}{4}$ .450.120	Ø 4,50 x 120°
F $\frac{1}{4}$ .230.120	Ø 2,30 x 120°	F $\frac{1}{4}$ .460.120	Ø 4,60 x 120°
F $\frac{1}{4}$ .240.120	Ø 2,40 x 120°	F $\frac{1}{4}$ .470.120	Ø 4,70 x 120°
F $\frac{1}{4}$ .250.120	Ø 2,50 x 120°	F $\frac{1}{4}$ .480.120	Ø 4,80 x 120°
F $\frac{1}{4}$ .260.120	Ø 2,60 x 120°	F $\frac{1}{4}$ .490.120	Ø 4,90 x 120°
F $\frac{1}{4}$ .270.120	Ø 2,70 x 120°	F $\frac{1}{4}$ .500.120	Ø 5,00 x 120°

パーツNo.

口径

パーツNo.

口径